

RELEVU HALA - CORP NOU
 PARTER
 SCARA 1 : 200
 PROPRIETAR : S.C. SOUTHERN PROPERTIES S.R.L.
 STR. POPA SAVU, NR.18, ET.1, CAM.102, SECT.1
 BUCURESTI

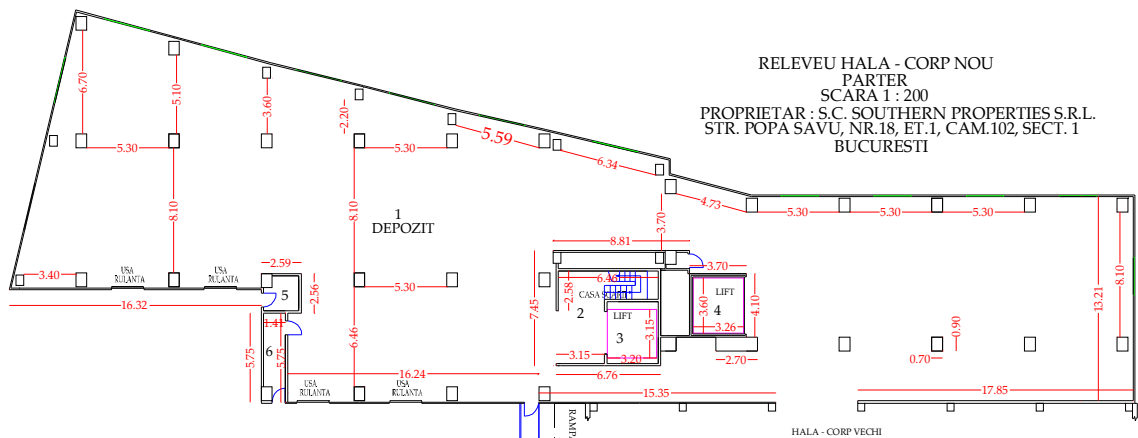

ADRESA IMOBILULUI :
 STR. GARA PROGRESULUI, NR.2, SECT.4
 BUCURESTII

Recapitulatie suprafete :

Nr. incapere	Denumire incapere	Suprafata utila - mp -
1	Depozit	1044.88
2	CASA SCARII	24.41
3	CASA LIFT	10.08
4	CASA LIFT	12.42
5	TABLOU ELECTRIC	4.77
6	CAMERA	7.56
SUPRAFATA UTILA TOTALA =		1104.12 mp.

Executant :
 Lupu Daniel

Data :
 1.10.2008